



BGK

CEILING TYPE HEAT RECOVERY DEVICES / Plate Heat Exchangers

Device Components and Material Properties

The body is manufactured from galvanized sheet metal. Some of the fans of the BGK are made of high quality galvanized steel which is resistant to corrosion and some models are made of aluminum material to meet their performance requirements. All models have an external rotor motor with closed structure. The device is capable of handling air at max.40°C. It consists of high efficiency plate heat exchanger, external rotor motor plug fan, filters and control panel components. An electric heater is available as an option.

Device Structure

Polyethylene insulation material is used for sound insulation and thermal insulation of the device body. There is a condensation pan designed to drain the condensate on the heat recovery exchanger.

Speed Control

Heated electric heater, low and high limit safety temperature thermostat.

Benefits

By means of the heat exchanger, the heat is transferred by means of heat exchanger without the mixture between the exhausted air and the fresh air taken from the outer space, pre-heating in winter conditions and pre-cooling in summer conditions. Since no extra energy is consumed in the meantime, some of the energy to be consumed for heating or cooling the fresh air is obtained from the indoor or outdoor air. Due to the recovery of exhaust heat, it reduces the initial investment and operating costs of air conditioning systems. The speed can be adjusted via the control panel. Easy access to plug fans and filters.

Usage Areas

School, hotel, shopping center, business centers, villa, hospital etc. structures where high amounts of fresh air are needed; It is used in cases where air freshening and air conditioning is desired to be done in an efficient way.

Technical Drawing and Tables

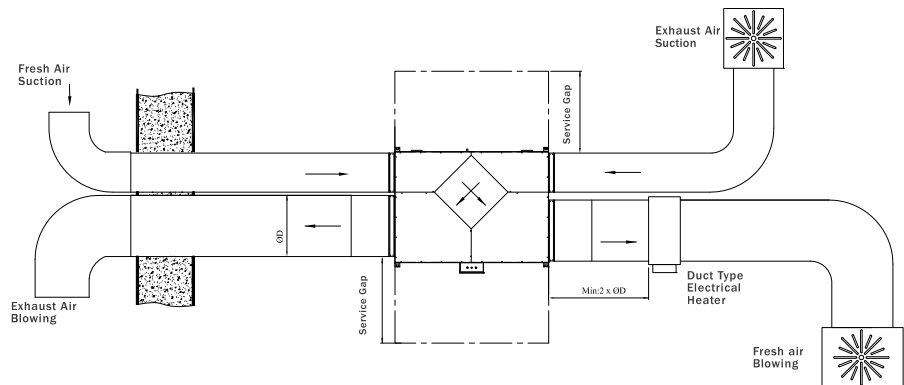
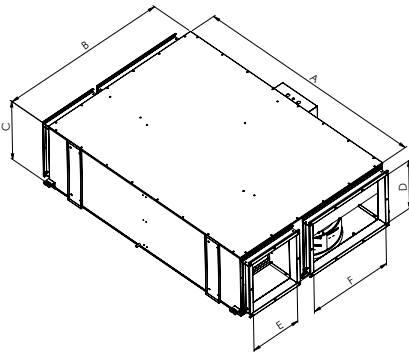

TYPE	A	B	C	D	E	F
BGK 75	1100	900	315	220	200	455
BGK 100	1200	1000	365	270	300	455
BGK 200	1500	1200	415	320	400	555
BGK 300	1700	1200	475	380	400	555
BGK 400	1800	1300	515	420	400	655
BGK 500	2000	1500	615	520	400	855

Dimensions are in (mm)

TYPE	VOLTAGE	FREQUENCY	POWER	CURRENT	CAPACITOR	SPEED	AIR FLOW	SOUND PRESSURE	INSULATION CLASS	PROTECTION CLASS	WEIGHT	ELECTRICAL HEATER	VOLTAGE OF ELECTRICAL HEATER
	V	Hz	W	(A)	(μF)	r.p.m	m³/h	dB(A)	Ins.cl.	IP	kg	kW	V
BGK 75	230	50	140X2	0,86X2	6	1440	750	46	F	44	80	3	380
BGK 100	230	50	200X2	1X2	8	1420	1000	46	F	44	113	3	380
BGK 200	230	50	310X2	1,55X2	10	1430	2000	48	F	44	150	5	380
BGK 300	230	50	500X2	2,5X2	10	1435	3000	49	F	44	180	8	380
BGK 400	230	50	780X2	3,5X2	16	1280	4000	54	F	44	200	10	380
BGK 500	230	50	1550X2	7,3X2	25	1250	5000	57	F	44	230	13	380

Sound Level Measured from 3m distance in room condition.

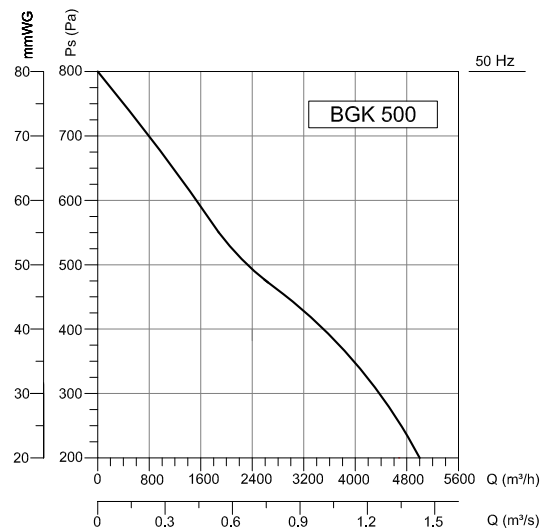
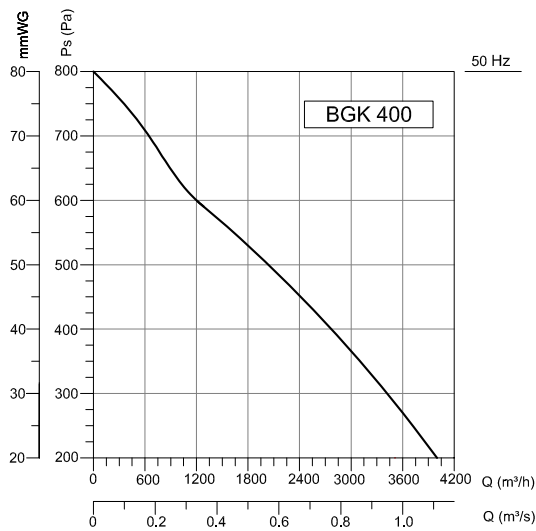
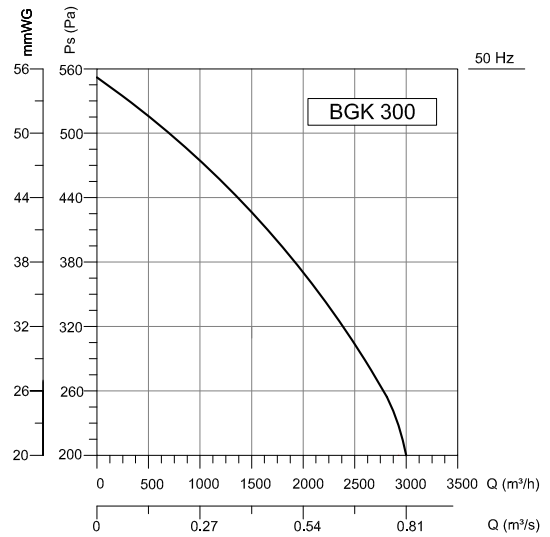
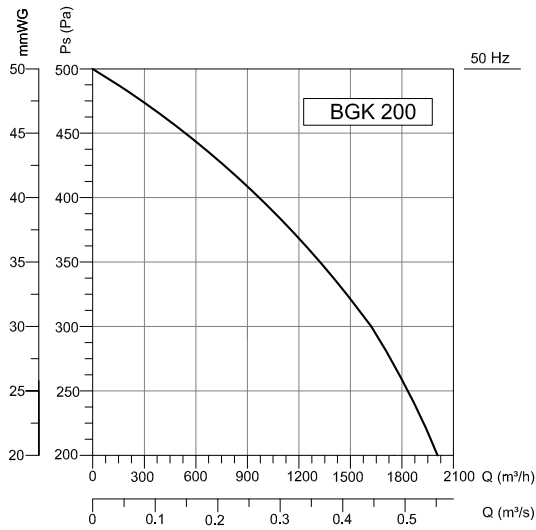
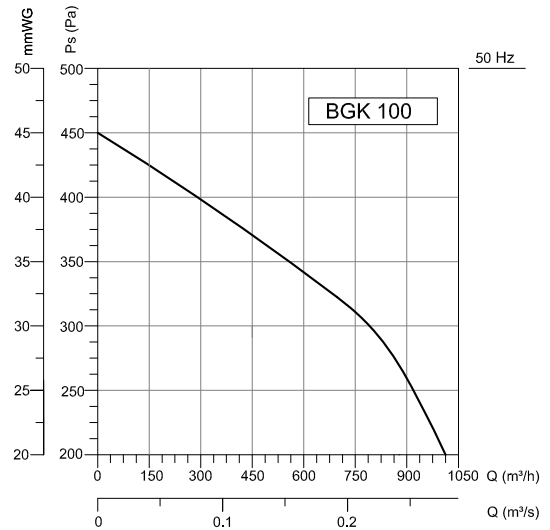
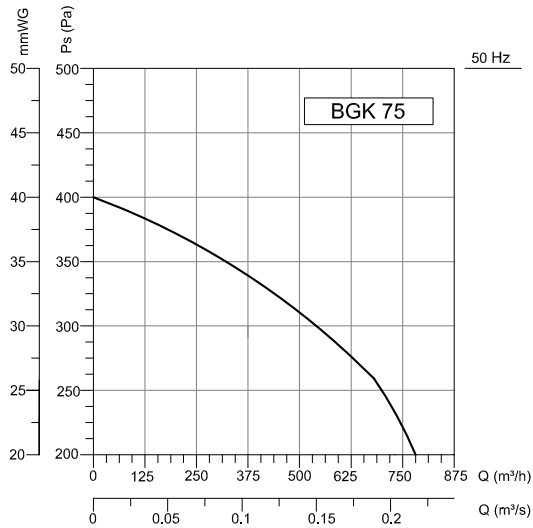

Accessories



BCTH



BFG2



BFG3



BFG4



BFH13



BDH



BDKS



BDEB